

NFRC Package

COMMERCIAL | RESIDENTIAL



*The **NFRC Package** offers maximum insulation values while helping comply with energy codes.*

ArmRLite's Custom CI Model when taken with insulated glass and our Energy Efficiency Package will provide an NFRC label and tested U-Factor and SHGC. Consult with ArmRLite on the specific values that your door size and glass options can provide.

U-Value VS. U-Factor

U-Factor: Measurement on how well a product can keep heat or cool air from escaping a room. The U-Factor provides an entire assembly value, the frame and glass combined. The lower the number the better the product is keeping heat or cool air in.

U-Value: Also measures how well a product can keep heat or cool air from escaping from a room. The U-Value provides a value on only the glazing used. The lower value the better.

*Most energy codes like Title 24 will require a tested U-Factor.

Air Tightness Tests

(Infiltration only)

@ 0.52 psf – equivalent to 15mph
Q = 0.03 cfm/ft²

@ 1.57 psf – equivalent to 25mph
Q = 0.04 cfm/ft²

@ 6.24 psf – equivalent to 50mph
Q = 0.06 cfm/ft²

NFRC Package



HELI-ARC WELDING METHOD

Lengths of 6063-T5 alloy hollow aluminum extrusions are cut to size for rails and stiles. Stiles are then contour-milled and accurately joined to the rails by concealed heli-arc welds to produce flush, hairline joints and framework unequalled in strength and durability.

1. Strong four-sided tubular extrusions are used rather than weaker three-sided which can crumple under pressure.
2. ArmRLite is the only glass garage door manufacturer that produces a welded frame. The most common construction method uses thru-bolts to hold sections together – which sag and separate over time, affecting curb appeal and reducing the performance life of the sections and door. Welds are permanent and outperform thru-bolted construction year after year! ArmRLite has used the same construction method starting with our first welded door in 1958. We can reproduce identical sections to replace impacted or damaged sections for all of our welded models – regardless of purchase date!

ENERGY EFFICIENCY / INSULATION OPTIONS

All of ArmRLite's welded aluminum and glass models are available with our exclusive Energy Efficiency Package for maximum insulation and water resistance.

1. After welding, polyurethane expanding foam is injected directly into the hollow four-sided extrusions. The foam expands and fills in every hollow space within the frame with insulation.
2. All meeting members are completely sealed, making the frame both insulated and water resistant. This process does not eliminate water infiltration.
3. Custom end caps are available as an upgrade to conceal any visible insulation in the end stiles against the track. Custom end caps are finished to match door frame, even if custom colors are used.

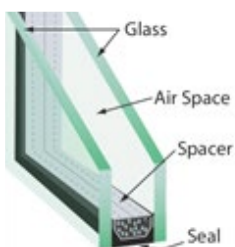
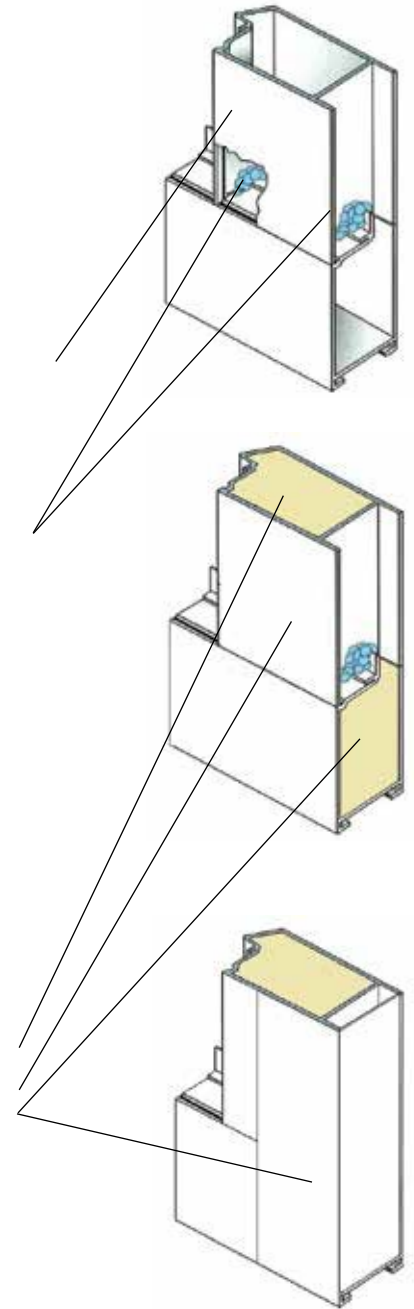

INSULATED GLASS

ArmRLite's insulated glass units are available with or without Low-E coatings for added thermal performance. Insulated units can be clear, frosted, tinted, or customized for your specific project. Insulated glass is available in varying thicknesses including: 1", 5/8" or 7/16" thick overall insulated glass unit.

