

Steel Carriage

RESIDENTIAL



Steel Carriage is a grooved panel, insulated overhead door designed to enhance the beauty of your home.

The Steel Carriage model is comprised of a 2" thick insulated sandwich panel constructed of top quality materials, highly detailed grooved panel embossment, deep pebblegrain texture, and two coat prefinished paint system.

SIZES AVAILABLE

DOOR WIDTH

8', 9', 10'

GROOVED PANELS



12', 14', 15'



16', 17', 18'



DOOR HEIGHT

6'6", 6'9", 7'0", 7'6", 7'9", 8'0"

Steel Carriage



FEATURES

Sandwich type construction with CFC free expanded polystyrene insulation pressure bonded between two sheets of 26 gauge hot dipped galvanized steel with 10.25 R value.

1.0 mil paint system includes .25 mil rust inhibiting primer and .75 mil exterior top coat that resists fading and chalking while providing consistent color from panel to panel.

20 gauge hot dipped galvanized steel hinge plates run the full height of each section at all hinge locations to facilitate the attachment of hinges, handles, struts, and step plates.

Rigid aluminum retainer provides added strength while securing replaceable U-shaped bottom weatherstrip.

Designs are protected by US patent #D487521.

Sections include **tongue and groove** meeting rails for superior strength and better sealing against wind, rain, and snow.

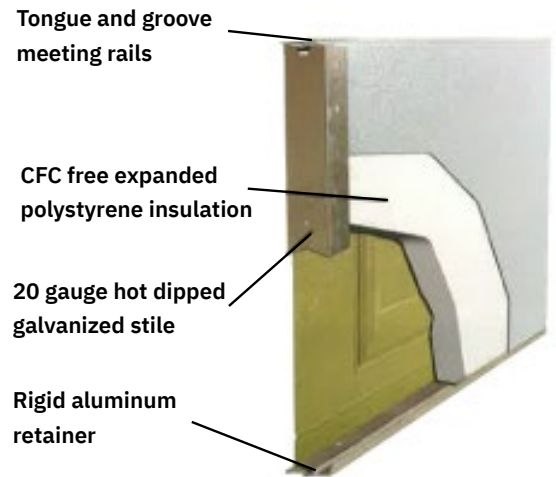

WINDOW DESIGN OPTIONS



SOMERTON

STANDARD



STOCKTON

STOCKTON-ARCH



STOCKBRIDGE

WYNBRIDGE

FINISH OPTIONS



WHITE



ALMOND

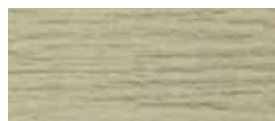

SANDSTONE